



Applications

- ✔ Full Brick

Vent Strip is installed on the bottom side of shelf angles, and mortar is tuck pointed below Vent Strip on top course of brick

Ventilation: Your Wall's Drying Engine

Drainage removes bulk liquid moisture from a wall, but a little moisture can still do a lot of damage. The key to drying out a wall assembly is to ventilate the rainscreen drainage gap. Vent Strip ventilates a brick cavity wall below the shelf angle to keep your walls dry and sustainable.

The MTI Advantage

- ✔ Maintains Airflow Passage at Top of Brick Veneer Wall Section
- ✔ Easy to Install
- ✔ 100% Recycled Content

Installation

- Adhere compressible filler (expansion strip) to the bottom of the shelf angle
- Install 4 9/16" Vent Strip™ with back edge of Vent Strip abutting the fabric face of the Sure Cavity™ and front edge extending approximately 1" past the front edge of shelf angle expansion material. Hold in place with dime size dabs of adhesive.
- Install course of brick below Vent Strip and tuck point in mortar between Vent Strip and brick.
- Tool joint and cut excess Vent Strip off while mortar is still plastic

Complete Installation at MTIdry.com/installation

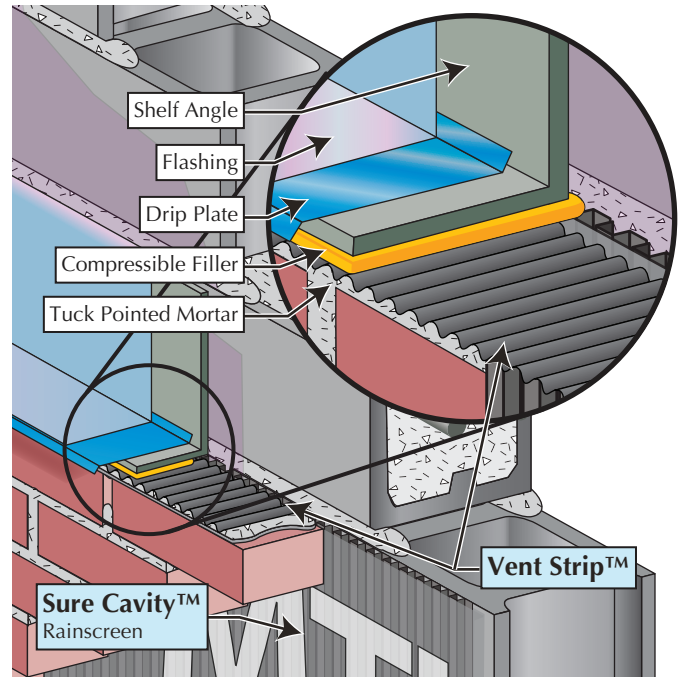

Technical Information

Material Description Corrugated plastic made of 0.6 mm pre-consumer recycled high-impact polystyrene .

Vent Strip VS 3845

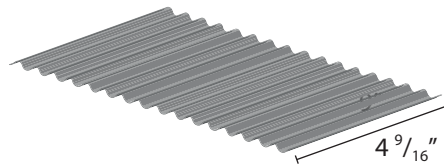
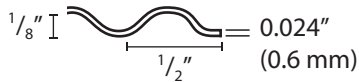

Related Products:

- Head Joint Weep™
- Sure Cavity Rainscreen™

Field-trim to appropriate width for masonry unit & cavity dimensions

Roll	50 ft
Bundle	150 ft / 3 rolls
Box	900 ft / 6 bundles

Questions about application, installation or ordering?
MTIdry.com/vent-strip