

Strike Off and Slope to Drain

The very common practice of using a mason's block trowel to strike off the grout in a bond beam results in a concave surface pattern in the grout.

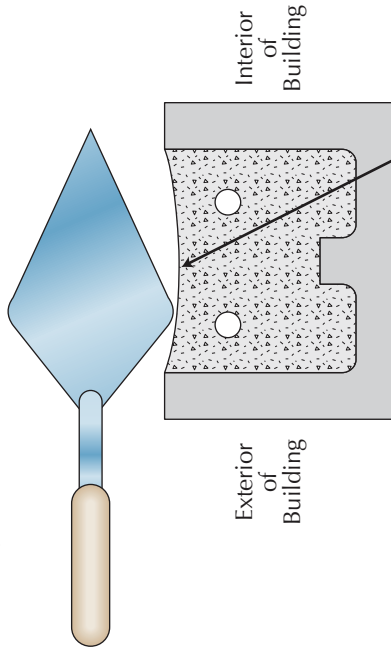

This concave pattern ponds water and allows it to leak into or, at least, to absorb into the CMU wall detail.

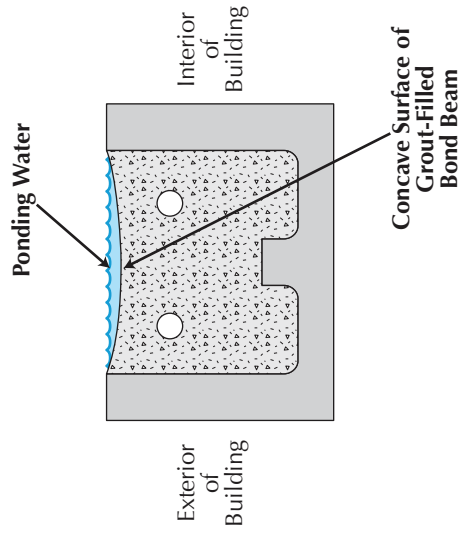

Strike off grout fill of a bond beam to slope to drain 1/4" in 12", with an MTI-STD 2518™ tool.

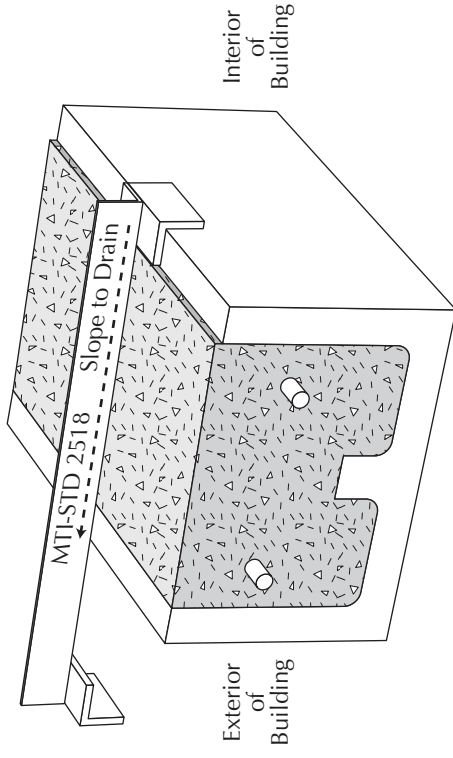

Coat with cement-based waterproofing and install a weep system.

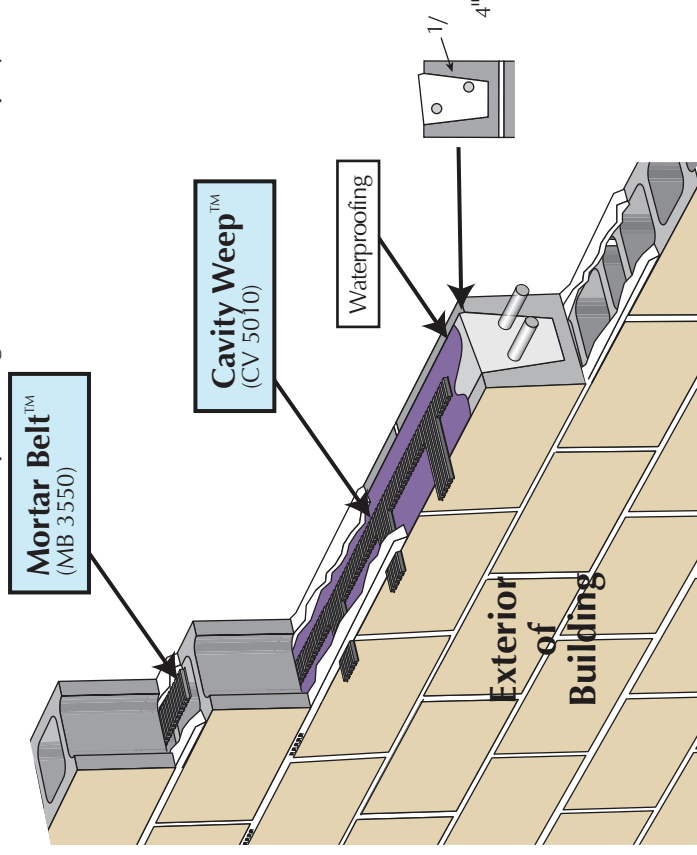

91NA00SW002

Copyright © Masonry Technology Incorporated, 2/2008, All Rights Reserved.

MTI details are created from sources deemed to be reliable. However, MTI does not guarantee the accuracy or completeness of any information, nor shall be held responsible for any errors, omissions, or damages arising out of the use of this information. These details are created with the understanding that MTI is providing information but is not attempting to render engineering or other professional service. If such services are required, the assistance of an appropriate professional should be sought. Use MTI materials in strict conformance with local building codes and regulations. Consult local code/code officials prior to installation. It is the buyer's responsibility to ensure that MTI materials are used in strict conformance with local building codes and regulations.