

# Thin Veneer Battered Walls – Post

**Sure Cavity™** (SC 5016, SC 5032) and **Cavity Weep™** (CV 5010) and **L&R Weep Screed™** (LR 3501) and **Vented Edge Metal™** (VMEM 3168)

## Caulking Detail

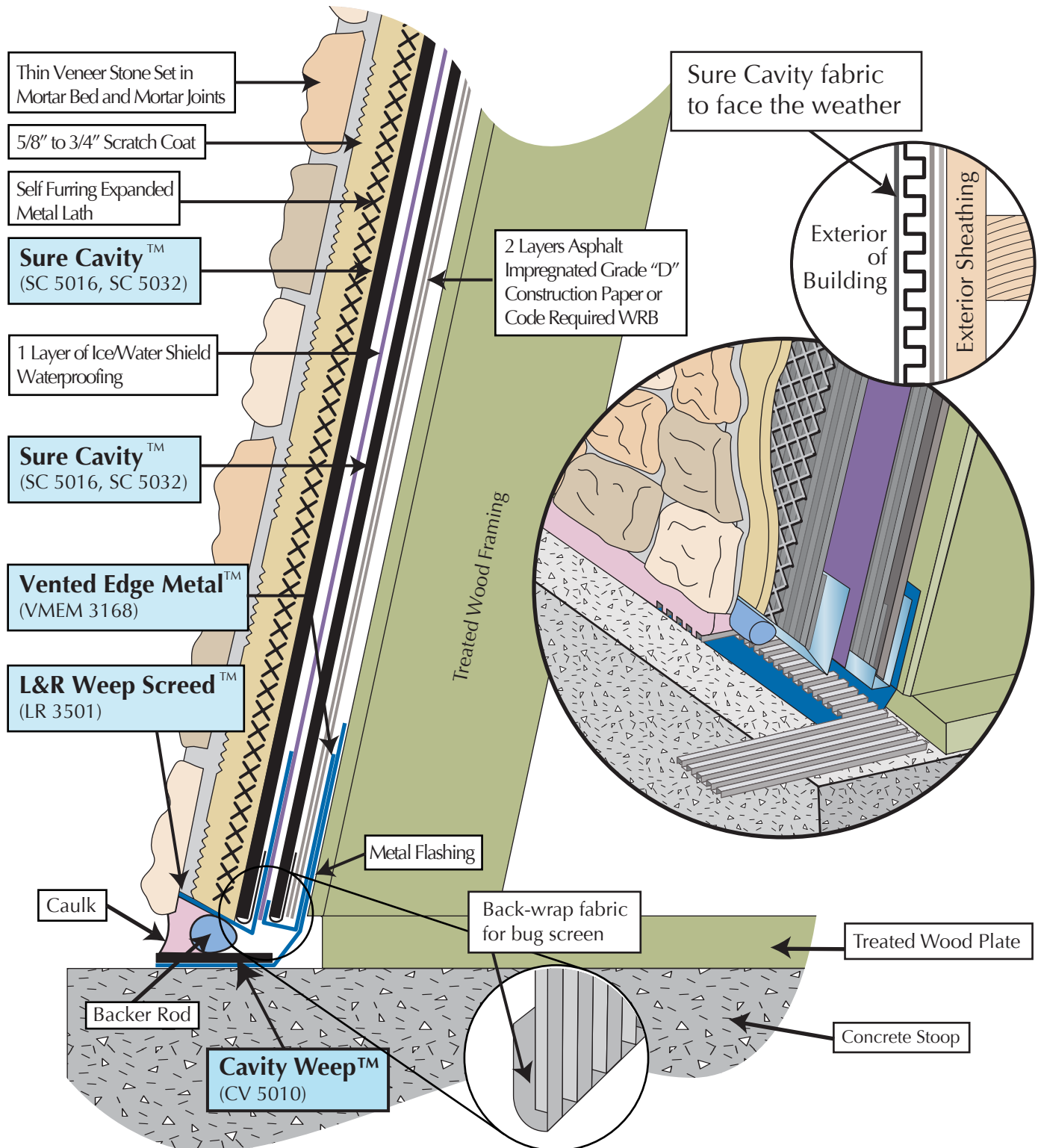

Copyright © Masonry Technology Incorporated, 1/2009, All Rights Reserved.

02TR02WD003

MTI CAD drawings are created from sources deemed to be reliable. However, MTI does not guarantee the accuracy or completeness of any information, nor shall be held responsible for any errors, omissions, or damages arising out of the use of this information. These drawings are created with the understanding that MTI is providing information but is not attempting to render engineering or other professional service. If such services are required, the assistance of an appropriate profession should be sought. Use MTI materials in strict conformance with local building codes and regulations. Consult local code/code officials prior to installation. It is the buyer's responsibility to ensure that MTI materials are used in strict conformance with local building codes and regulations.