

Lap Siding with Corrugated Lath Strip

Corrugated Lath Strip™ (CLS 3845-316 or CLS 3845-18), Vented MTI Edge Metal™ (VMEM 3168) and Moisture Diverter™ (DS 2858)

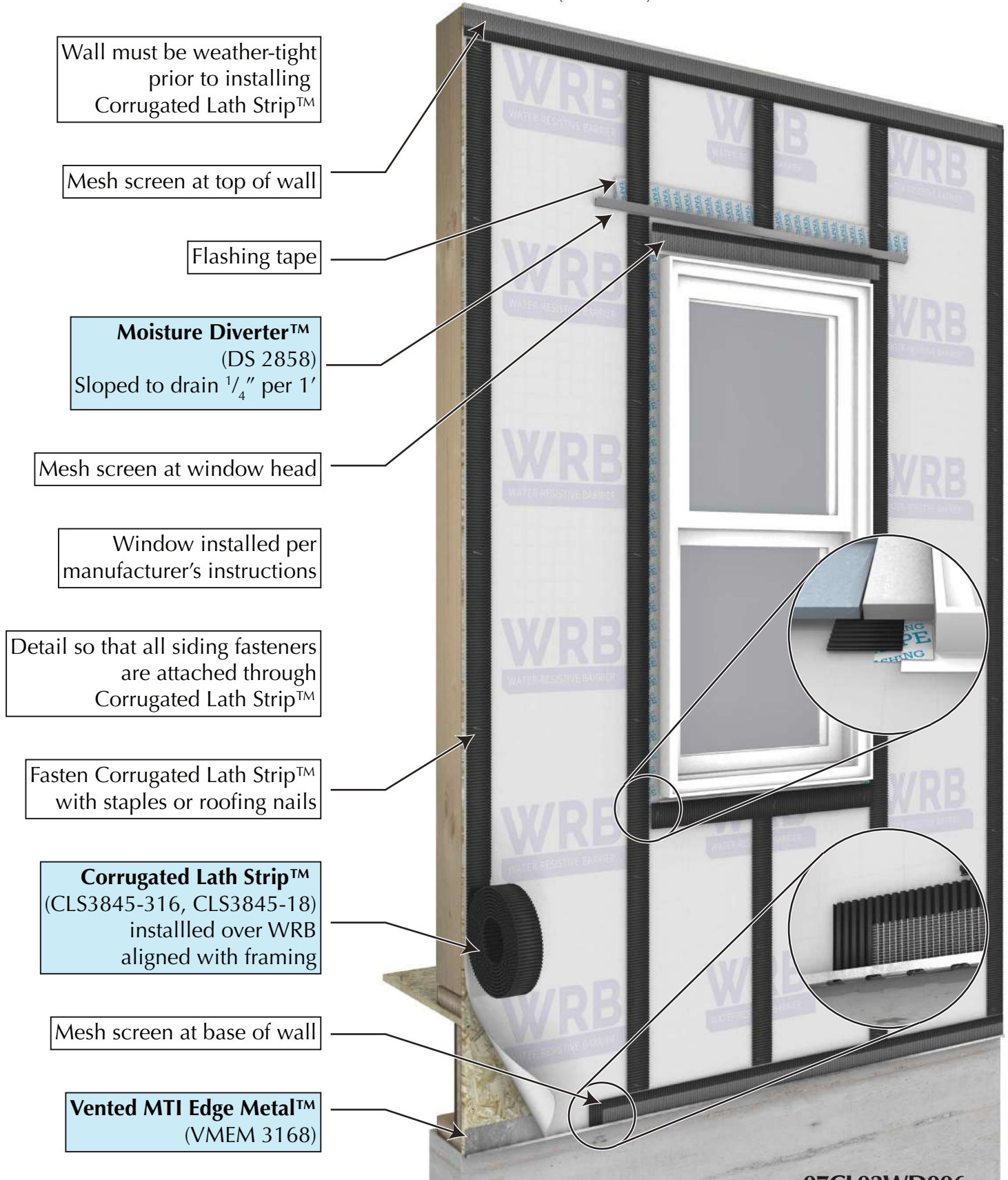

Wall must be weather-tight prior to installing Corrugated Lath Strip™

Mesh screen at top of wall

Flashing tape

Moisture Diverter™
(DS 2858)
Sloped to drain 1/4" per 1'

Mesh screen at window head

Window installed per manufacturer's instructions

Detail so that all siding fasteners are attached through Corrugated Lath Strip™

Fasten Corrugated Lath Strip™ with staples or roofing nails

Corrugated Lath Strip™
(CLS3845-316, CLS3845-18)
installed over WRB aligned with framing

Mesh screen at base of wall

Vented MTI Edge Metal™
(VMEM 3168)

Copyright © Masonry Technology Incorporated, 2019 All Rights Reserved.

07CL03WD006

MTI details are created from sources deemed to be reliable. However, MTI does not guarantee the accuracy or completeness of any information, nor shall be held responsible for any errors, omissions, or damages arising out of the use of this information. These details are created with the understanding that MTI is providing information but is not attempting to render engineering or other professional service. If such services are required, the assistance of an appropriate profession should be sought. Use MTI materials in strict conformance with local building codes and regulations. Consult local code/code officials prior to installation. It is the buyer's responsibility to ensure that MTI materials are used in strict conformance with local building codes and regulations.

1-800-879-3348 | MTIdry.com

