

STRIKE OFF GROUT FILL OF A BOND BEAM TO SLOPE TO SLOPE TO DRAIN 1/4" IN 12", WITH AN MTI-STD 2518™ TOOL.

THE VERY COMMON PRACTICE OF USING A MASON'S BLOCK TOWEL TO STRIKE OFF THE GROUT IN A BOND BEAM RESULTS IN A CONCAVE SURFACE PATTERN IN THE GROUT

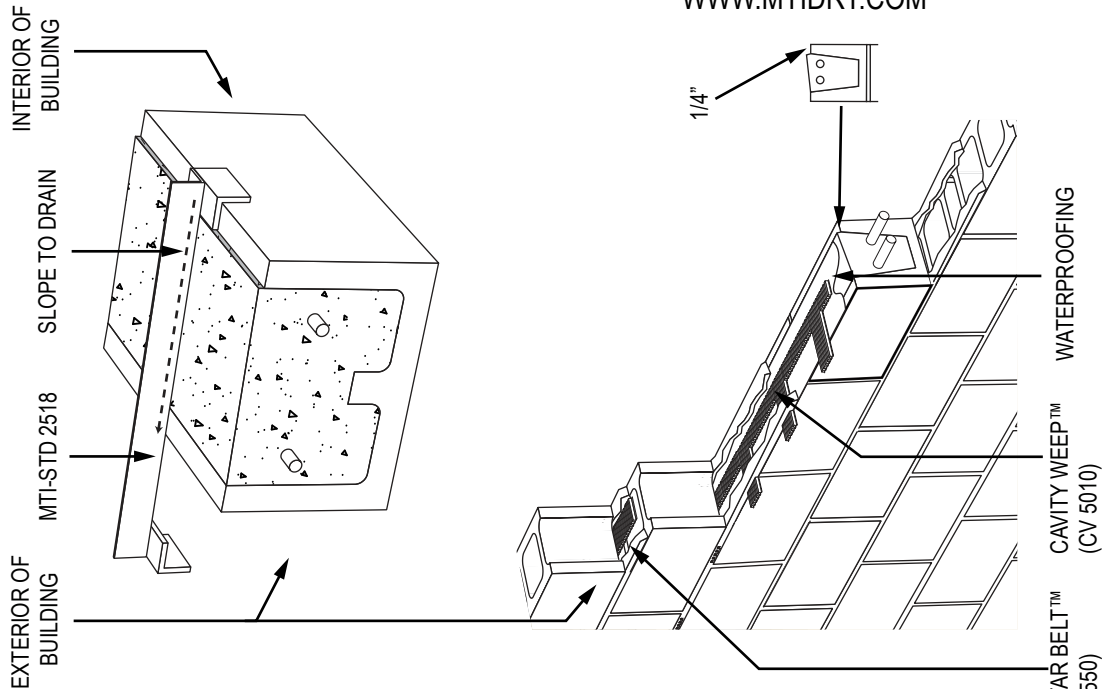

COAT WITH CEMENT-BASED WATERPROOFING AND INSTALL A WEEP SYSTEM.

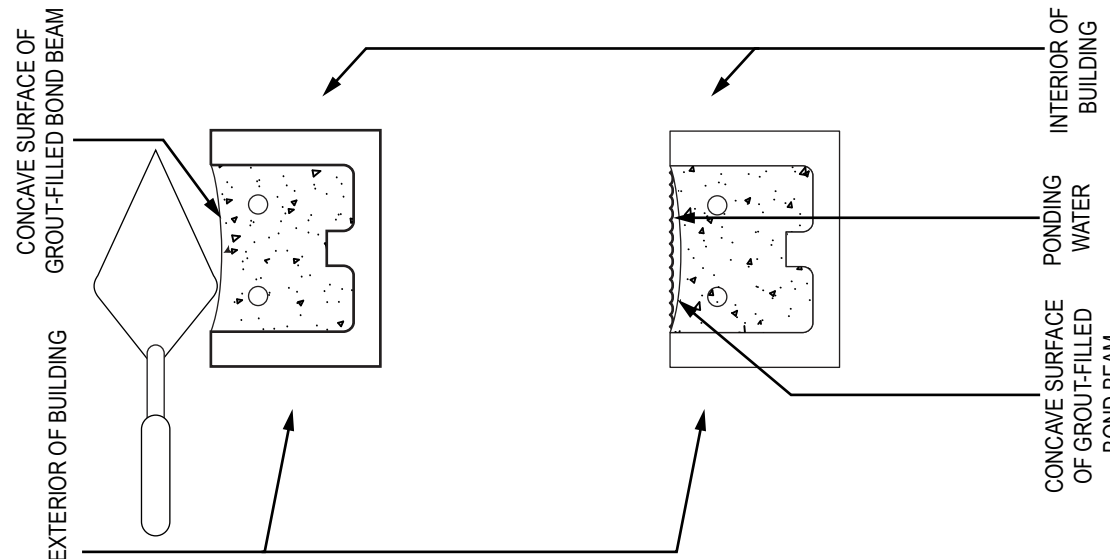

THE CONCAVE PATTERN PONDS WATER AND ALLOWS IT TO LEAK INTO OR, AT LEAST, TO ABSORB INTO THE CMU WALL DETAIL.

**NOTES:**

1. INSTALLATION TO BE COMPLETED IN ACCORDANCE WITH MANUFACTURER'S SPECIFICATIONS.
2. DO NOT SCALE DRAWINGS
3. CONTRACTORS NOTE: FOR PRODUCT AND COMPANY INFORMATION VISIT [WWW.MTIDRY.COM](http://WWW.MTIDRY.COM)

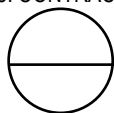

**STRIKE OFF AND SLOPE TO DRAIN**

MTI CAD drawings are created from sources deemed to be reliable. However, MTI does not guarantee the accuracy or completeness of any information, nor shall be held responsible for any errors, omissions, or damages arising out of the use of this information. These drawings are created with the understanding that MTI is providing information but is not attempting to render engineering or other professional service. If such services are required, the assistance of an appropriate profession should be sought. Use MTI materials in strict conformance with local building codes and regulations. Consult local code/code officials prior to installation. It is the buyer's responsibility to ensure that MTI materials are used in strict conformance with local building codes and regulations.