

Vented MTI Edge Metal™

VMEM 3168

Designed for Moisture Control

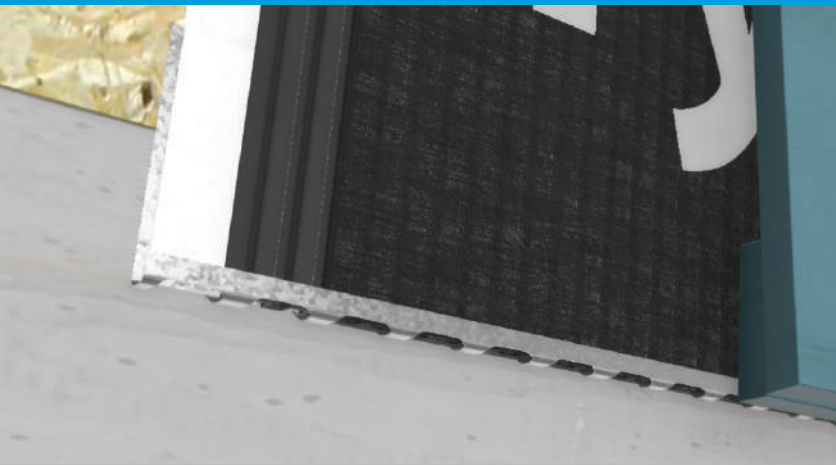

Applications

- ✔ Siding
- ✔ Roof Systems
- ✔ Thin Veneers with Cement Board

Vented Edge Metal drains a rainscreen siding assembly

Rainscreen Compatible Vented Termination

An air gap allows gravity to drain your walls dry, but that water needs an exit strategy at terminations. Vented MTI Edge Metal is designed to fit the Sure Cavity rainscreen and features large slots for weeping the rainscreen air gap. Use Vented MTI Edge Metal with roofs, thin veneers over cement board and siding applications.



Vented MTI Edge Metal features large slots for drainage

The MTI Advantage

- ✔ Accommodates Rainscreen Drainage Mat
- ✔ Large Slots Designed to Weep & Ventilate

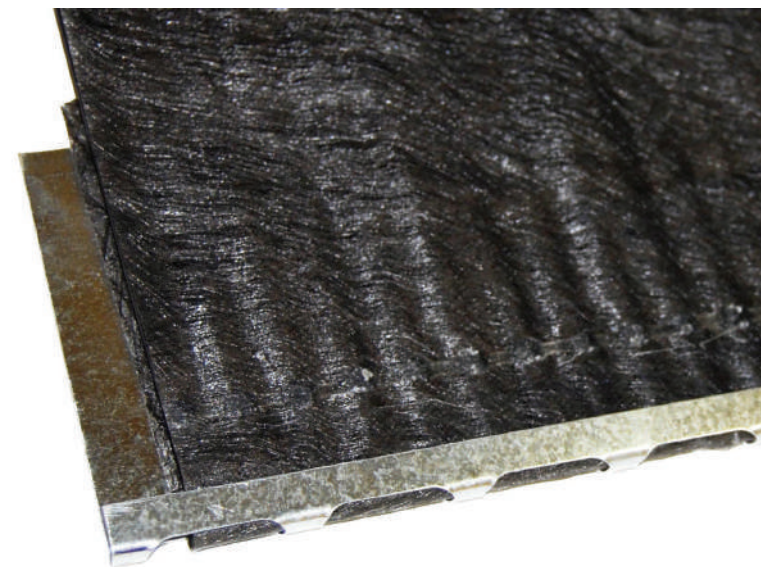

Drains & vents the Sure Cavity™ rainscreen drainage plane

Installation

- Install Vented MTI Edge Metal™ below foundation plate line - a minimum of 4" above the grade
- Ensure the water resistive barrier and Sure Cavity™ rainscreen overlap the 3 1/2" attachment flange and are fully seated in the bottom of the Vented MTI Edge Metal
- Vented MTI Edge Metal can also be used as part of a roof drainage system beneath shingles.

Complete Installation at MTIdry.com/installation

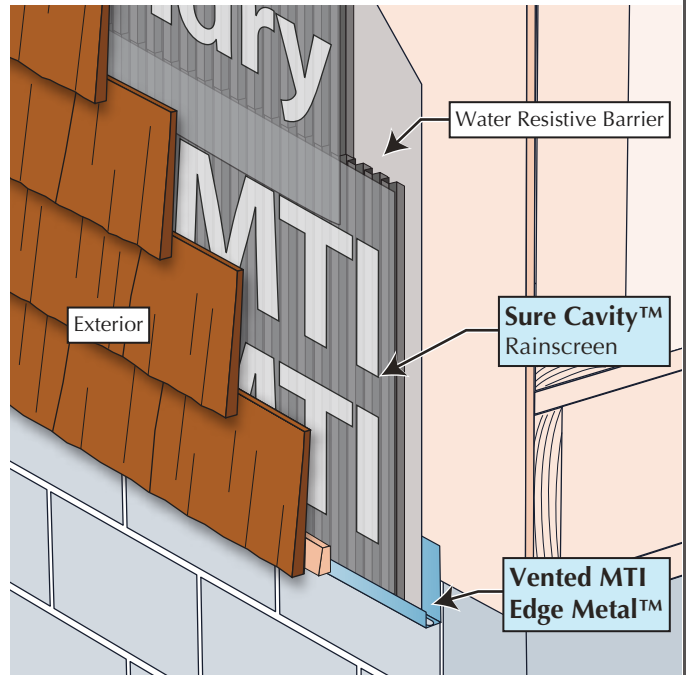

Technical Information

Material Description .0217" (26 Gauge) Cold Rolled Galvanized Steel

Vented MTI Edge Metal VMEM 3168

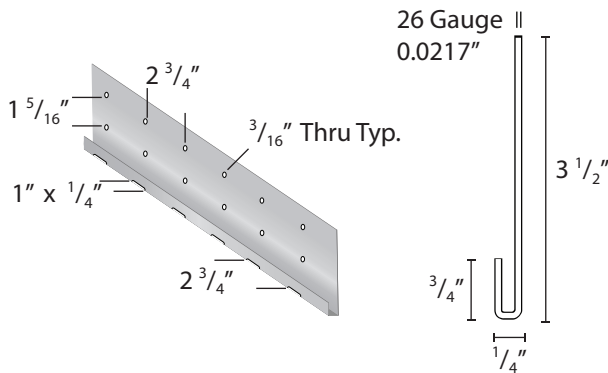

Related Products:

- MTI Edge Metal™
- Sure Cavity™ Rainscreen

Piece	8 ft
Tube	104 ft / 13 pieces
Can be custom made in other metals upon request	

Questions about application, installation or ordering?
MTIdry.com/vented-edge-metal

