

Thin Stone Veneer at Bottom of Wall With L&R Weep Screenshot™

Sure Cavity™ (SC 5016 or SC 5032) or **Gravity Cavity™** (GC 1816 or GC 1832) or **10MM Sure Cavity™** (SCMM 2516 or SCMM 2532) and **L+R Weep Screenshot™** (LR 3501)

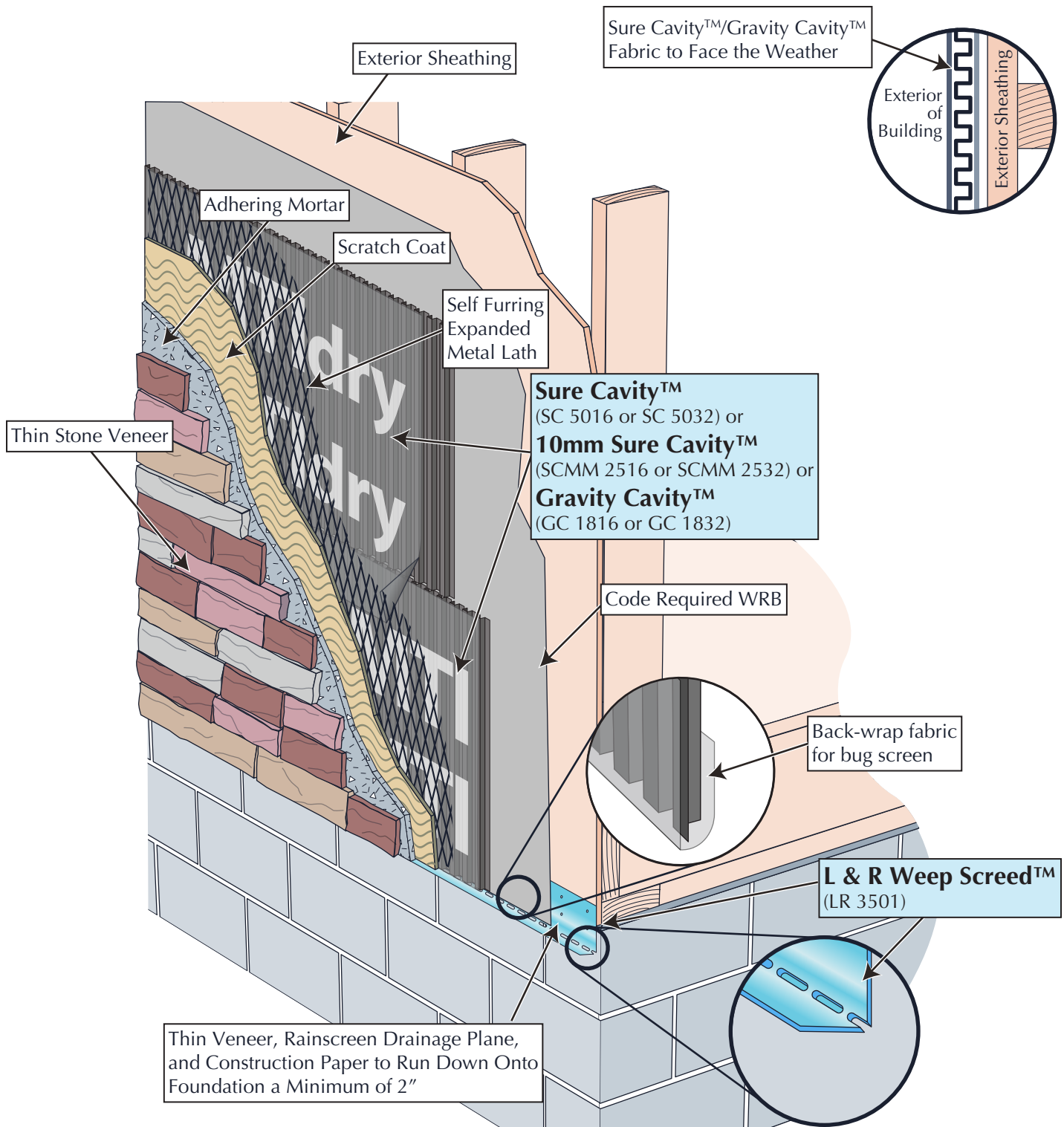

Copyright © Masonry Technology Incorporated, 2018 All Rights Reserved.

MTI details are created from sources deemed to be reliable. However, MTI does not guarantee the accuracy or completeness of any information, nor shall be held responsible for any errors, omissions, or damages arising out of the use of this information. These details are created with the understanding that MTI is providing information but is not attempting to render engineering or other professional service. If such services are required, the assistance of an appropriate profession should be sought. Use MTI materials in strict conformance with local building codes and regulations. Consult local code/code officials prior to installation. It is the buyer's responsibility to ensure that MTI materials are used in strict conformance with local building codes and regulations.

01TR02WD001

1-800-879-3348 | MTIdry.com

MTI MASONRY TECHNOLOGY INCORPORATED

Thin Stone Veneer Run To Grade with Waterproofing on Foundation Wall

Sure Cavity™ (SC 5016 or SC 5032) or 10mm Sure Cavity™ (SCMM 2516 or SCMM 2532) or Gravity Cavity™ (GC 1816 or GC 1832) and Wall Opening Weeps™ (WOW 9095)

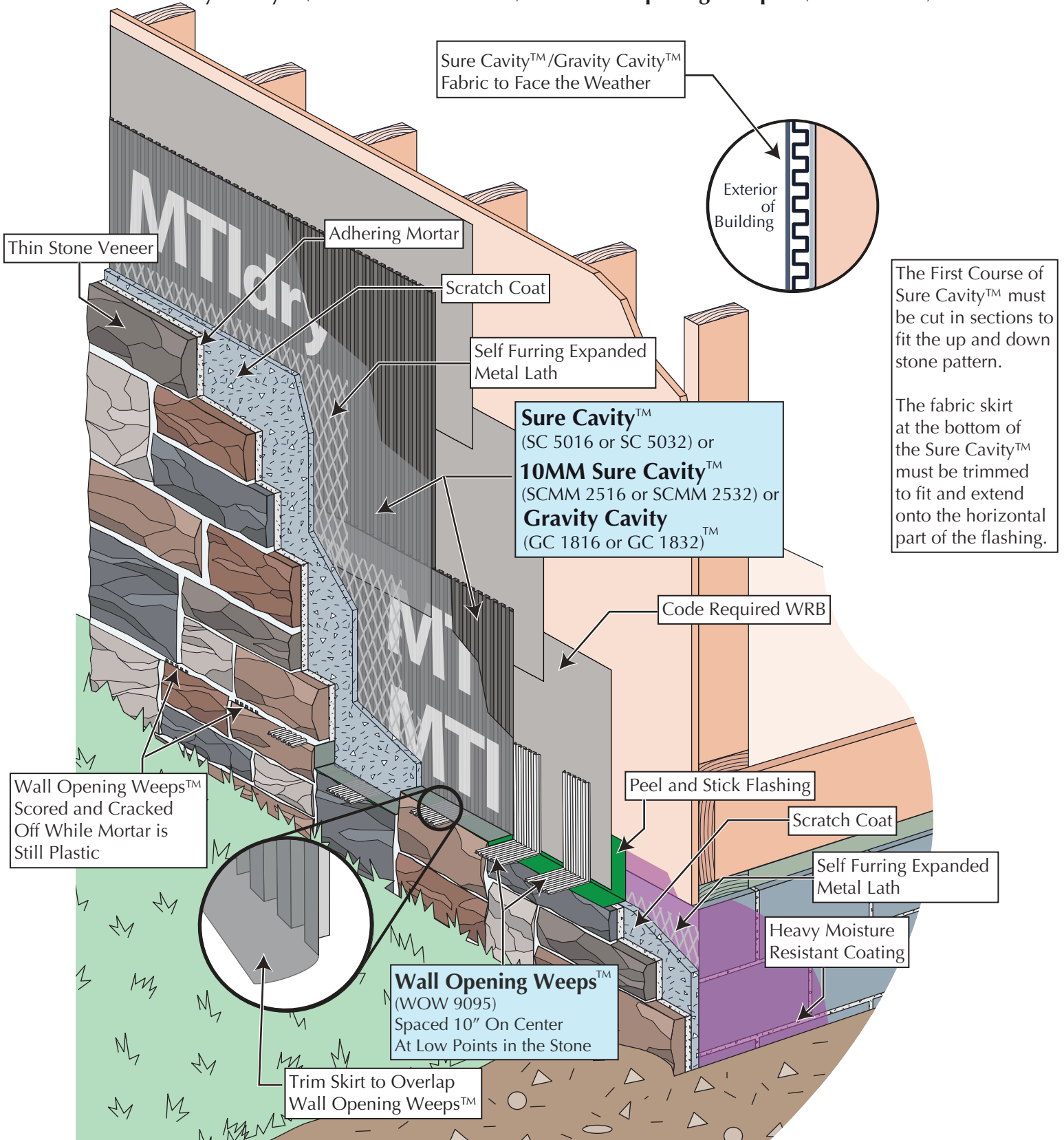

Copyright © Masonry Technology Incorporated, 2018 All Rights Reserved.

MTI details are created from sources deemed to be reliable. However, MTI does not guarantee the accuracy or completeness of any information, nor shall be held responsible for any errors, omissions, or damages arising out of the use of this information. These details are created with the understanding that MTI is providing information but is not attempting to render engineering or other professional service. If such services are required, the assistance of an appropriate profession should be sought. Use MTI materials in strict conformance with local building codes and regulations. Consult local code/code officials prior to installation. It is the buyer's responsibility to ensure that MTI materials are used in strict conformance with local building codes and regulations.

01TR10WD003

1-800-879-3348 | MTIdry.com

MTI MASONRY TECHNOLOGY INCORPORATED

Thin Stone Veneer at Bottom of Window with Cut Stone Sill

Sure Cavity™ (SC 5016 or SC 5032) or 10mm Sure Cavity™ (SCMM 2516 or SCMM 2532) or Gravity Cavity™ (GC 1816 or GC 1832)

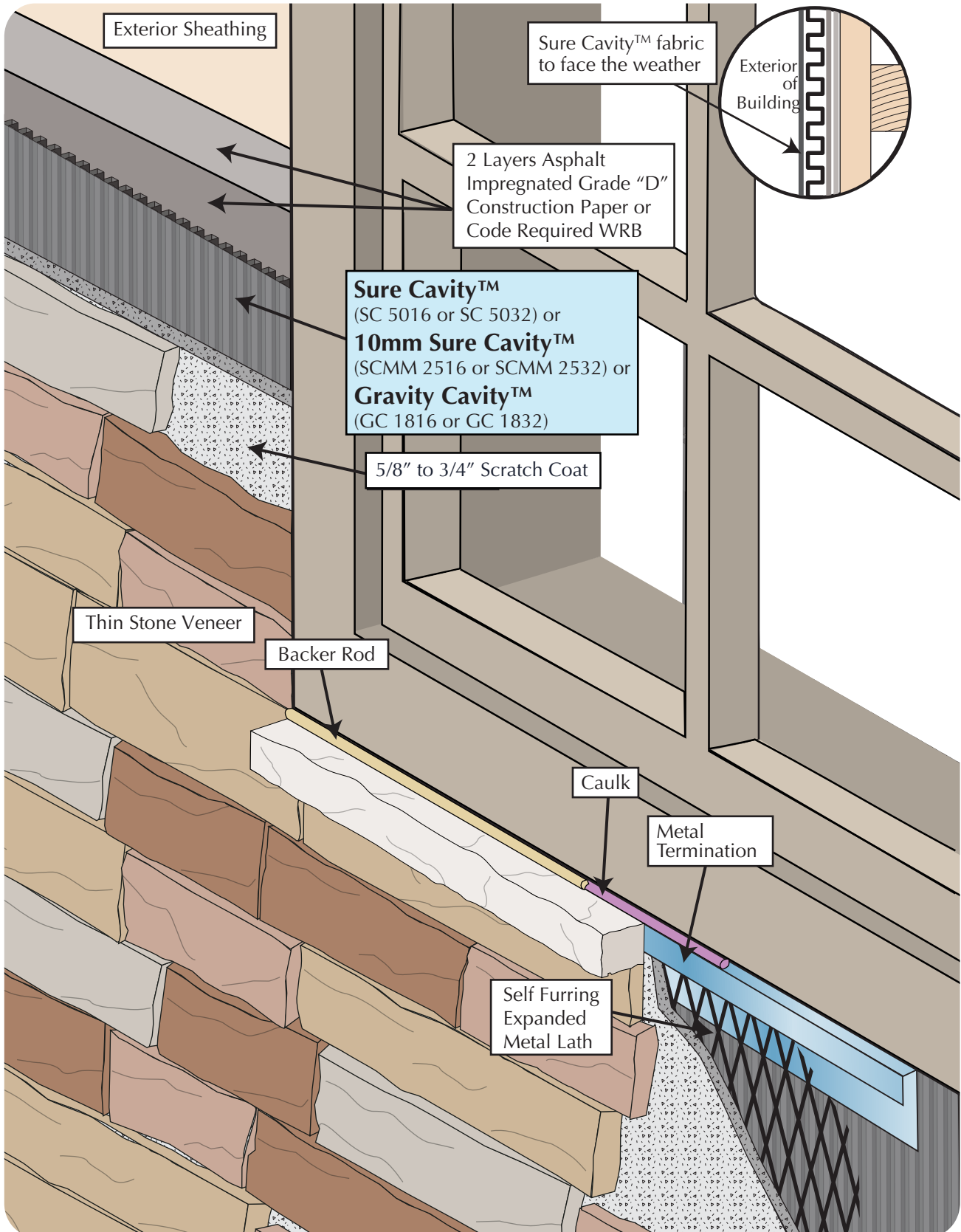

Copyright © Masonry Technology Incorporated, 2009 All Rights Reserved.

01TR03WD003

1-800-879-3348 | MTIdry.com

MTI MASONRY
TECHNOLOGY
INCORPORATED

MTI details are created from sources deemed to be reliable. However, MTI does not guarantee the accuracy or completeness of any information, nor shall be held responsible for any errors, omissions, or damages arising out of the use of this information. These details are created with the understanding that MTI is providing information but is not attempting to render engineering or other professional service. If such services are required, the assistance of an appropriate profession should be sought. Use MTI materials in strict conformance with local building codes and regulations. Consult local code/code officials prior to installation. It is the buyer's responsibility to ensure that MTI materials are used in strict conformance with local building codes and regulations.

Thin Stone Veneer Weep Systems and Drainage Plane with Moisture Diverter™ at Top of Window

Sure Cavity™ (SC 5016 or SC 5032) or 10mm Sure Cavity™ (SCMM 2516 or SCMM 2532) or Gravity Cavity™ (GC 1816 or GC 1832) and Wall Opening Weeps™ (WOW 9095) and Moisture Diverter™ (WSD 2858)

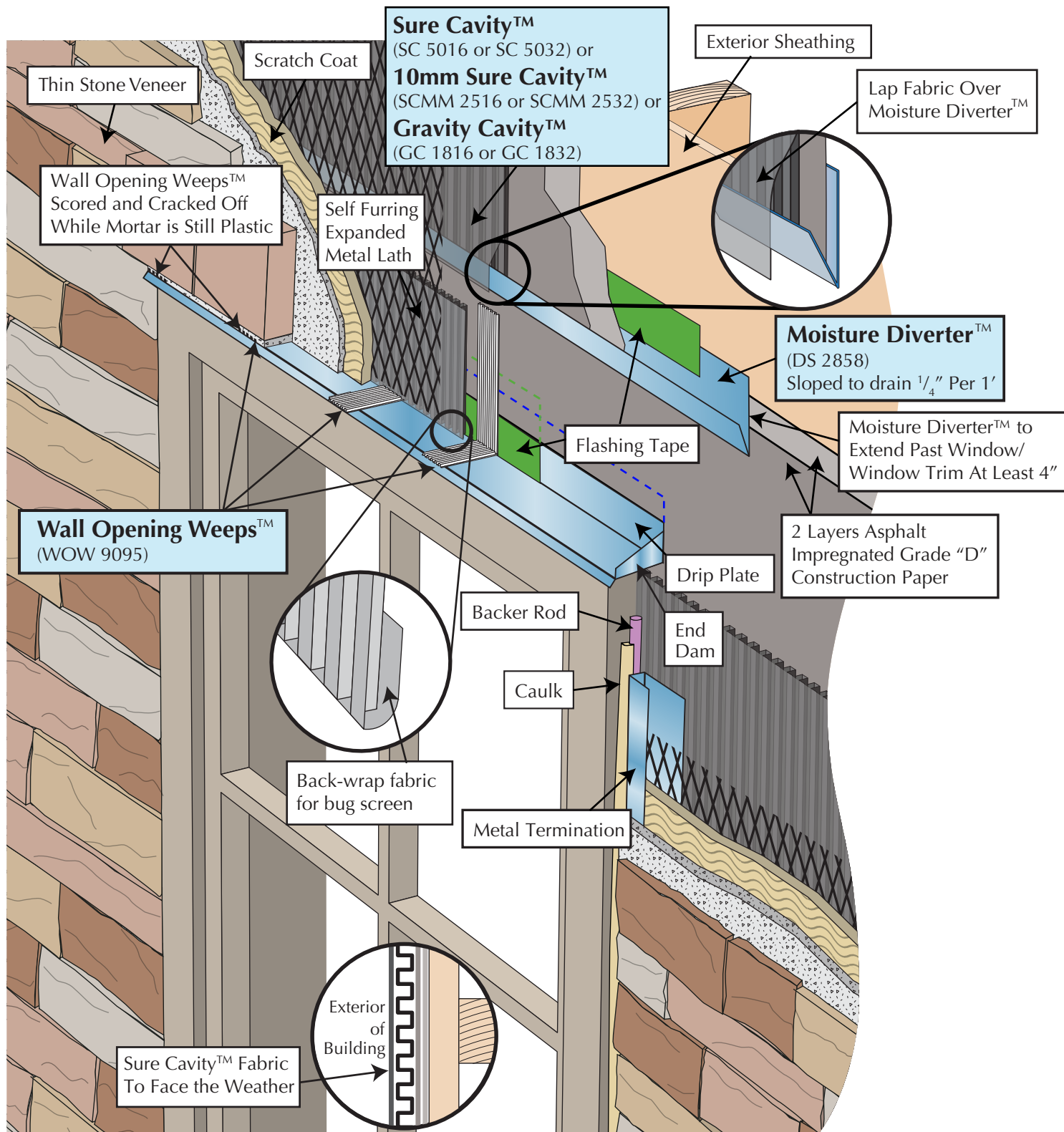

1-800-879-3348 | MTIdry.com



Copyright © Masonry Technology Incorporated, 2012 All Rights Reserved.

MTI details are created from sources deemed to be reliable. However, MTI does not guarantee the accuracy or completeness of any information, nor shall be held responsible for any errors, omissions, or damages arising out of the use of this information. These details are created with the understanding that MTI is providing information but is not attempting to render engineering or other professional service. If such services are required, the assistance of an appropriate profession should be sought. Use MTI materials in strict conformance with local building codes and regulations. Consult local code/code officials prior to installation. It is the buyer's responsibility to ensure that MTI materials are used in strict conformance with local building codes and regulations.

01TR03WD002

Thin Stone Veneer to Top-Vented Wall Stopped at Soffit

Sure Cavity™ (SC 5016 or SC 5032) or 10mm Sure Cavity™ (SCMM 2516 or SCMM 2532) or Gravity Cavity™ (GC 1816 or GC 1832)

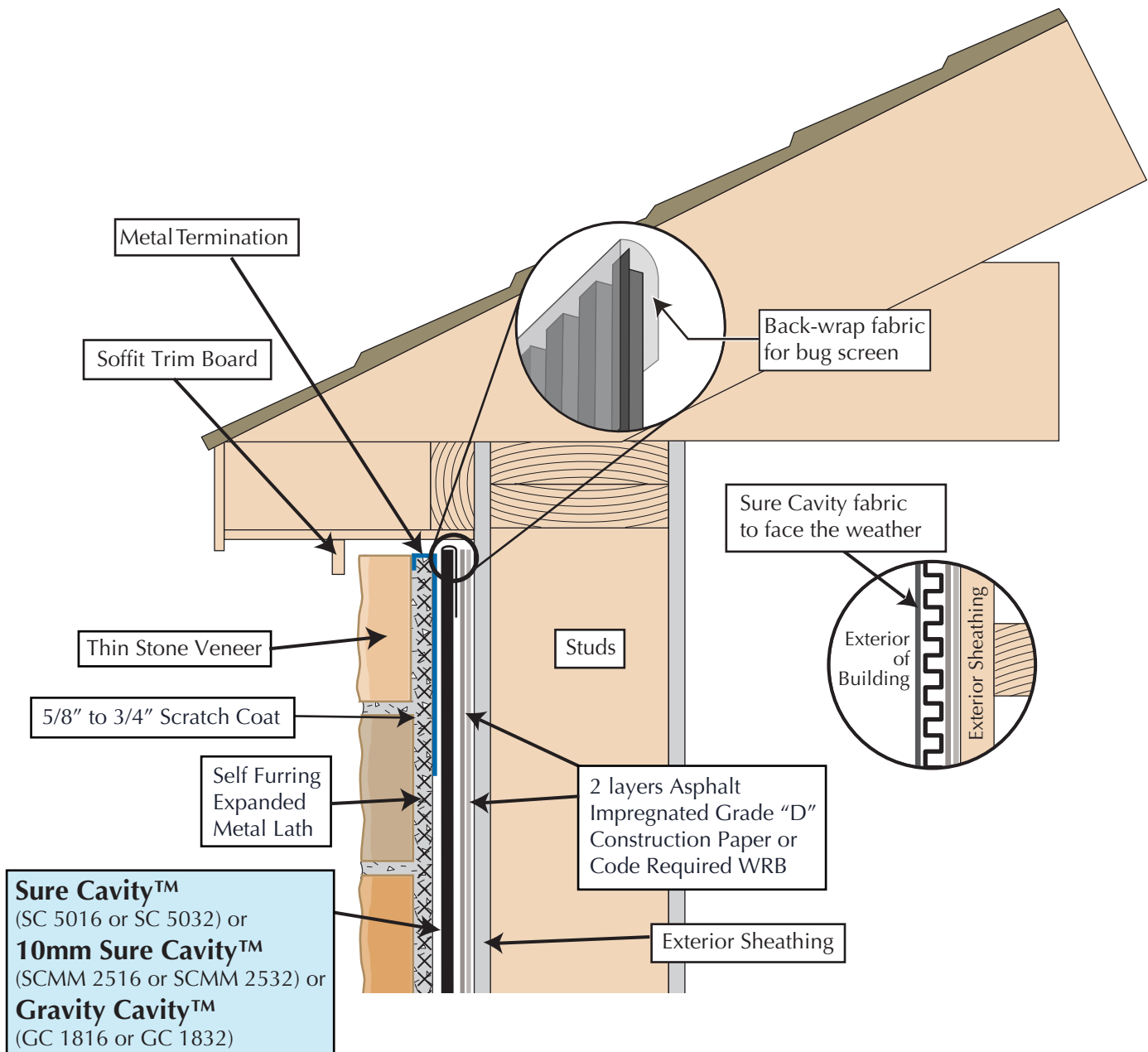

01TR05WD001

Copyright © Masonry Technology Incorporated, 2009 All Rights Reserved.

MTI details are created from sources deemed to be reliable. However, MTI does not guarantee the accuracy or completeness of any information, nor shall be held responsible for any errors, omissions, or damages arising out of the use of this information. These details are created with the understanding that MTI is providing information but is not attempting to render engineering or other professional service. If such services are required, the assistance of an appropriate profession should be sought. Use MTI materials in strict conformance with local building codes and regulations. Consult local code/code officials prior to installation. It is the buyer's responsibility to ensure that MTI materials are used in strict conformance with local building codes and regulations.

1-800-879-3348 | MTIdry.com

