

# Cladding (Siding) at Bottom of Wall Installation with Vented MTI Edge Metal™

Sure Cavity™ (SC 5016 or SC 5032) or Gravity Cavity™ (GC 1816 or GC 1832) and  
Vented Edge Metal™ (VMEM 3168)

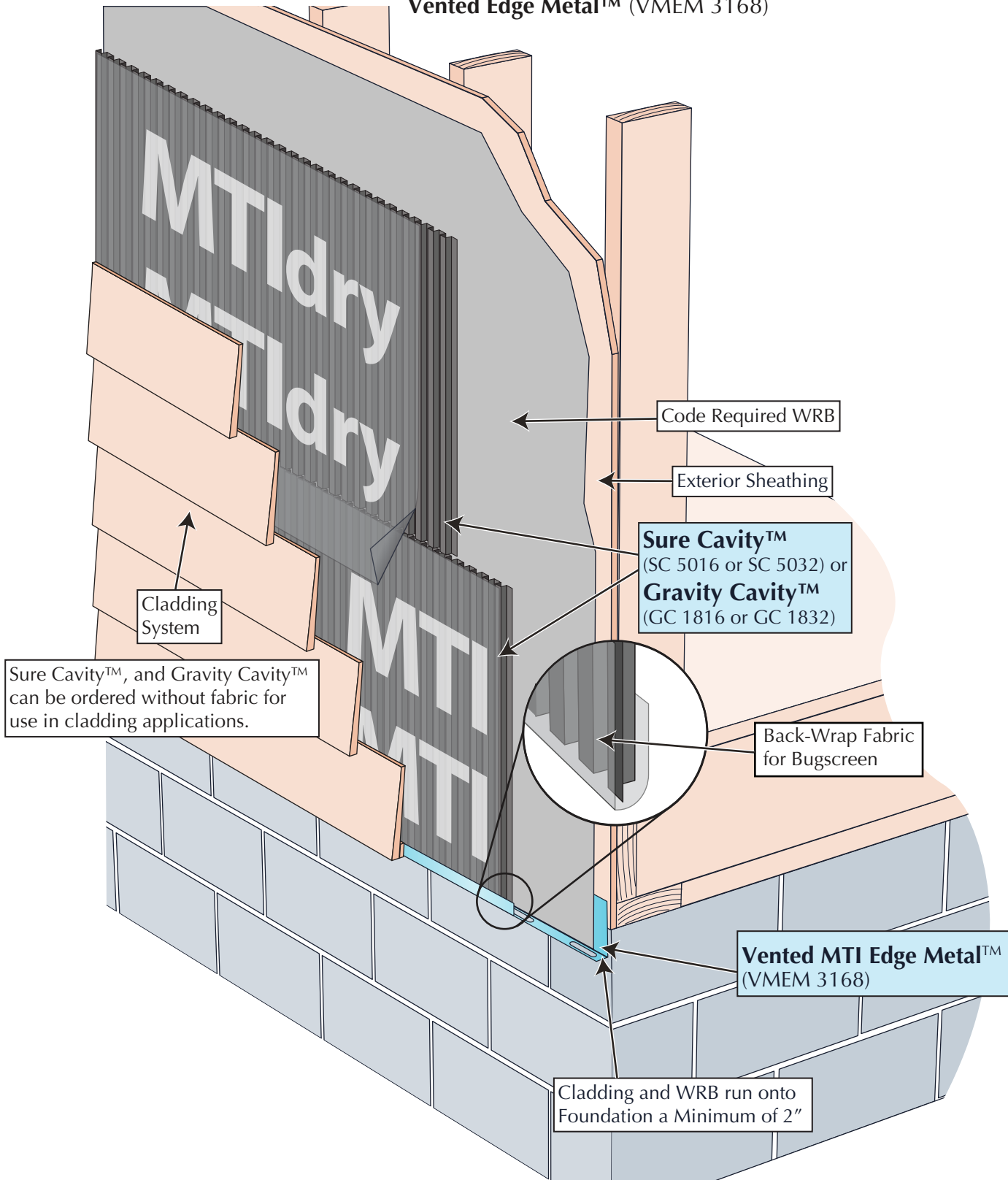

Copyright © Masonry Technology Incorporated, 2018 All Rights Reserved.

MTI details are created from sources deemed to be reliable. However, MTI does not guarantee the accuracy or completeness of any information, nor shall be held responsible for any errors, omissions, or damages arising out of the use of this information. These details are created with the understanding that MTI is providing information but is not attempting to render engineering or other professional service. If such services are required, the assistance of an appropriate profession should be sought. Use MTI materials in strict conformance with local building codes and regulations. Consult local code/code officials prior to installation. It is the buyer's responsibility to ensure that MTI materials are used in strict conformance with local building codes and regulations.

07CL02WD003

1-800-879-3348 | MTIdry.com

**MTI** MASONRY  
TECHNOLOGY  
INCORPORATED

# Cladding Installed at Inside Corner

Sure Cavity™ (SC 5016 or SC 5032) or 10mm Sure Cavity™ (SCMM 2516 or SCMM 2532) or Gravity Cavity™ (GC 1816 or GC 1832)

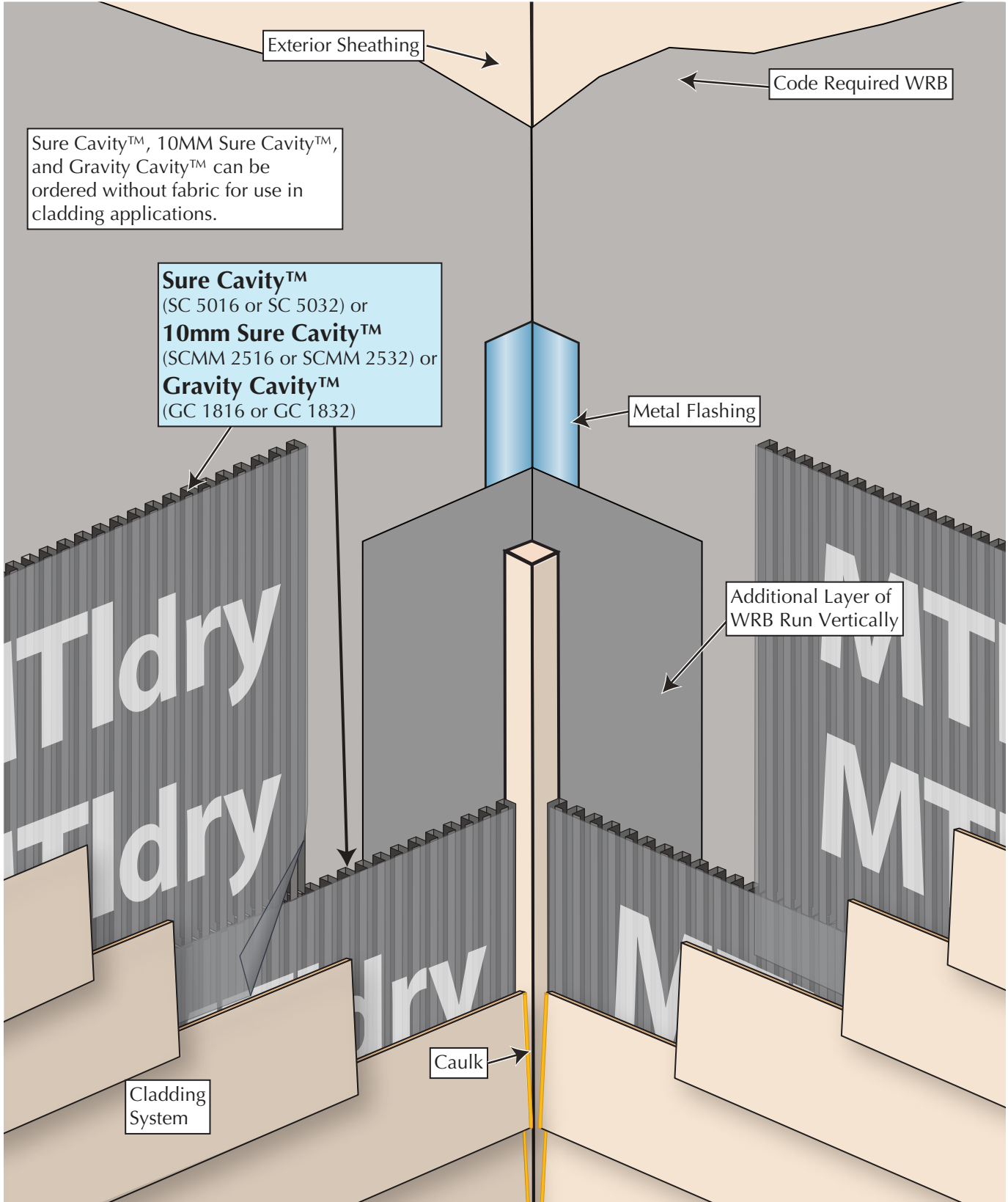

07CL14WD001

Copyright © Masonry Technology Incorporated, 2018 All Rights Reserved.

MTI details are created from sources deemed to be reliable. However, MTI does not guarantee the accuracy or completeness of any information, nor shall be held responsible for any errors, omissions, or damages arising out of the use of this information. These details are created with the understanding that MTI is providing information but is not attempting to render engineering or other professional service. If such services are required, the assistance of an appropriate profession should be sought. Use MTI materials in strict conformance with local building codes and regulations. Consult local code/code officials prior to installation. It is the buyer's responsibility to ensure that MTI materials are used in strict conformance with local building codes and regulations.

1-800-879-3348 | MTIdry.com

**MTI** MASONRY  
TECHNOLOGY  
INCORPORATED

# Cladding to Window with Moisture Diverter™ Installation

Sure Cavity™ (SC 5016 or SC 5032) or 10mm Sure Cavity™ (SCMM 2516 or SCMM 2532) or Gravity Cavity™ (GC 1816 or GC 1832) and Moisture Diverter™ (DS 2858)  
**Perspective View at Top of Window**

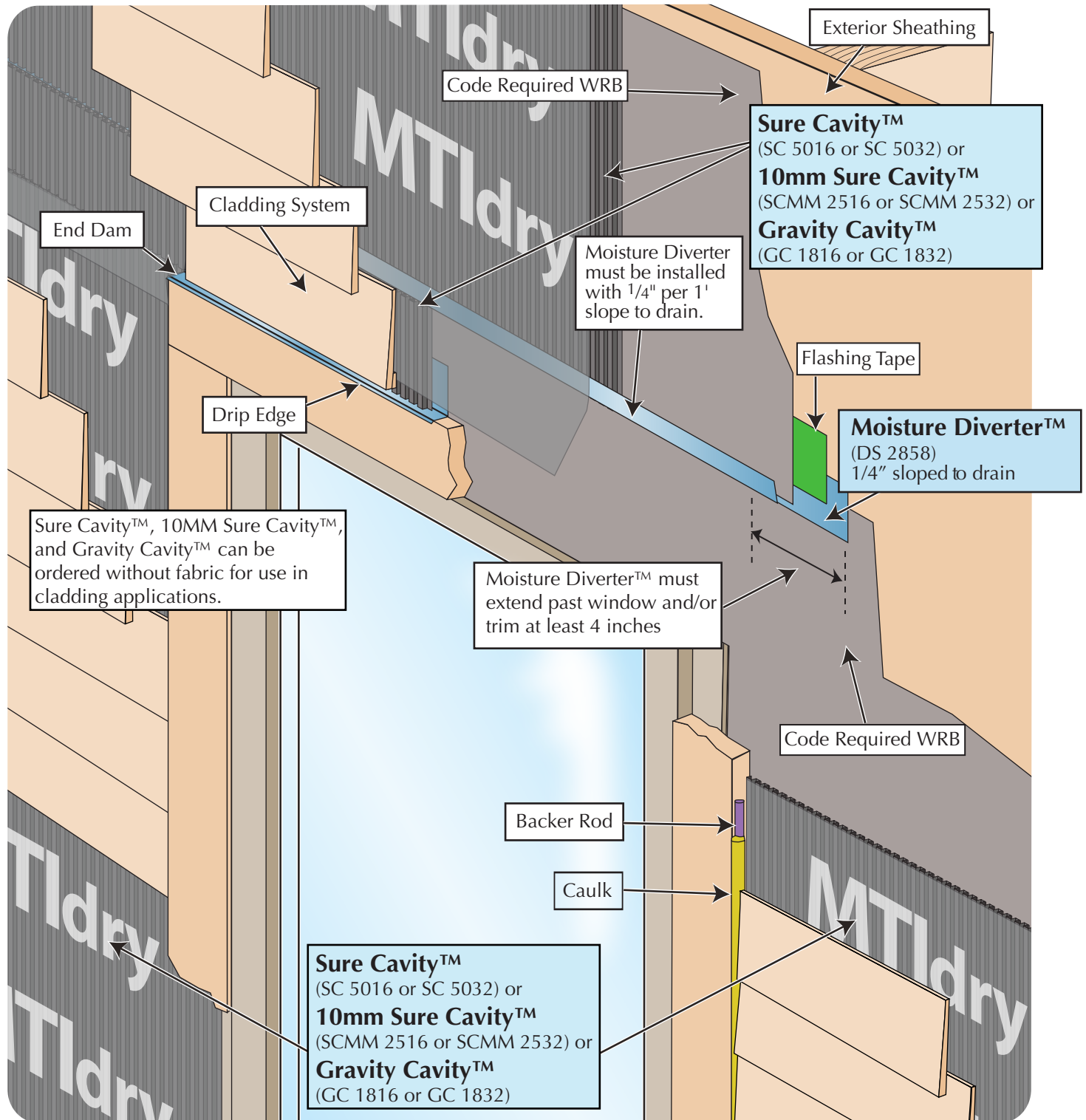

1-800-879-3348 | MTIdry.com



Copyright © Masonry Technology Incorporated, 2018 All Rights Reserved.

07CL03WD004

MTI details are created from sources deemed to be reliable. However, MTI does not guarantee the accuracy or completeness of any information, nor shall be held responsible for any errors, omissions, or damages arising out of the use of this information. These details are created with the understanding that MTI is providing information but is not attempting to render engineering or other professional service. If such services are required, the assistance of an appropriate profession should be sought. Use MTI materials in strict conformance with local building codes and regulations. Consult local code/code officials prior to installation. It is the buyer's responsibility to ensure that MTI materials are used in strict conformance with local building codes and regulations.

# Cladding to Top-Vented Wall Stopped at Soffit Installation

Sure Cavity™ (SC 5016 or SC 5032) or 10mm Sure Cavity™ (SCMM 2516 or SCMM 2532) or Gravity Cavity™ (GC 1816 or GC 1832)

## Side View

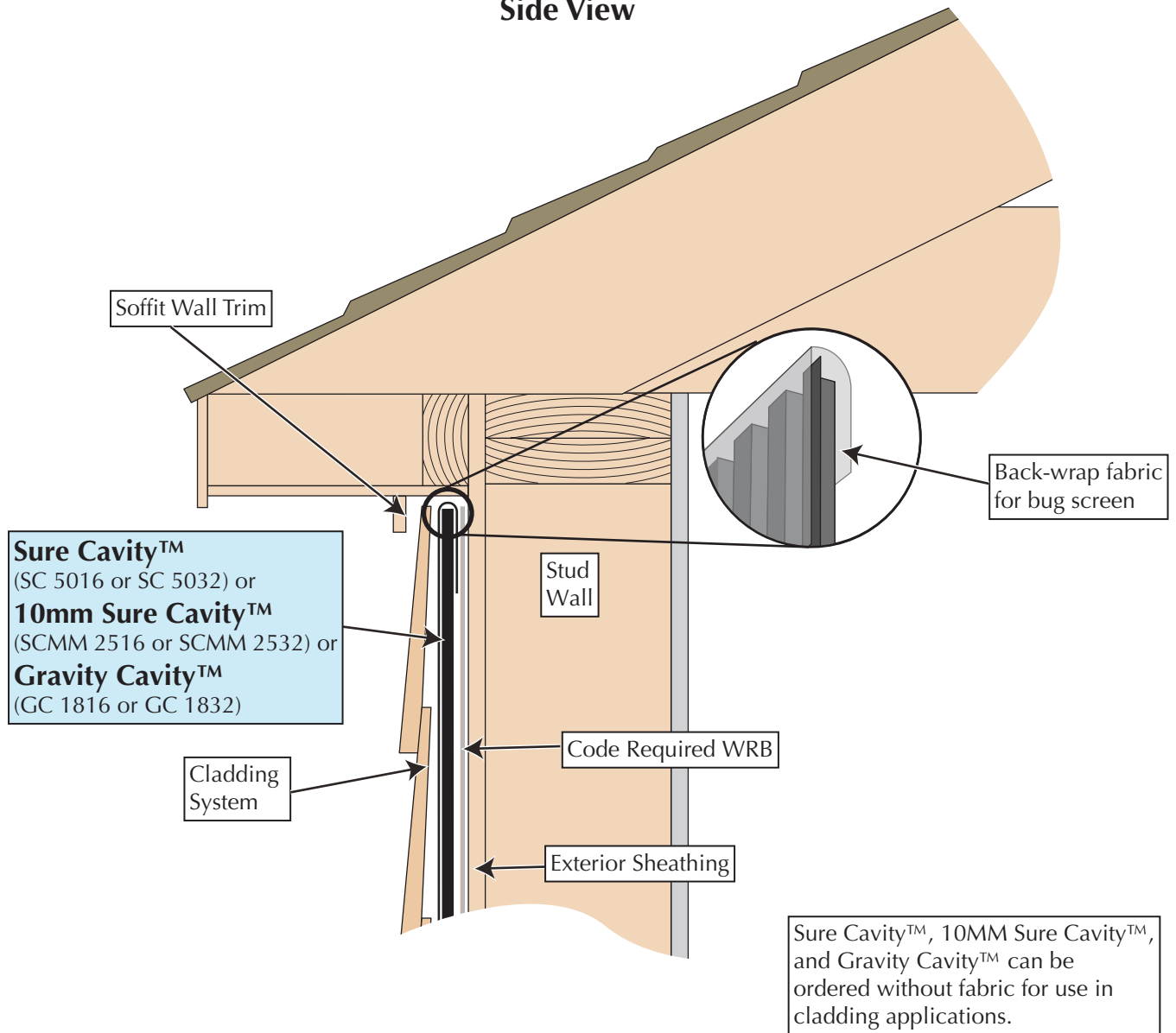

1-800-879-3348 | MTIdry.com



Copyright © Masonry Technology Incorporated, 2018 All Rights Reserved.

MTI details are created from sources deemed to be reliable. However, MTI does not guarantee the accuracy or completeness of any information, nor shall be held responsible for any errors, omissions, or damages arising out of the use of this information. These details are created with the understanding that MTI is providing information but is not attempting to render engineering or other professional service. If such services are required, the assistance of an appropriate profession should be sought. Use MTI materials in strict conformance with local building codes and regulations. Consult local code/code officials prior to installation. It is the buyer's responsibility to ensure that MTI materials are used in strict conformance with local building codes and regulations.

07CL05WD001

# Siding At Bottom of Wall With Corrugated Lath Strip™

Corrugated Lath Strip™ (CLS 3845-18 or CLS 3845-316)  
and Vented Edge Metal™ (VMEM 3168)

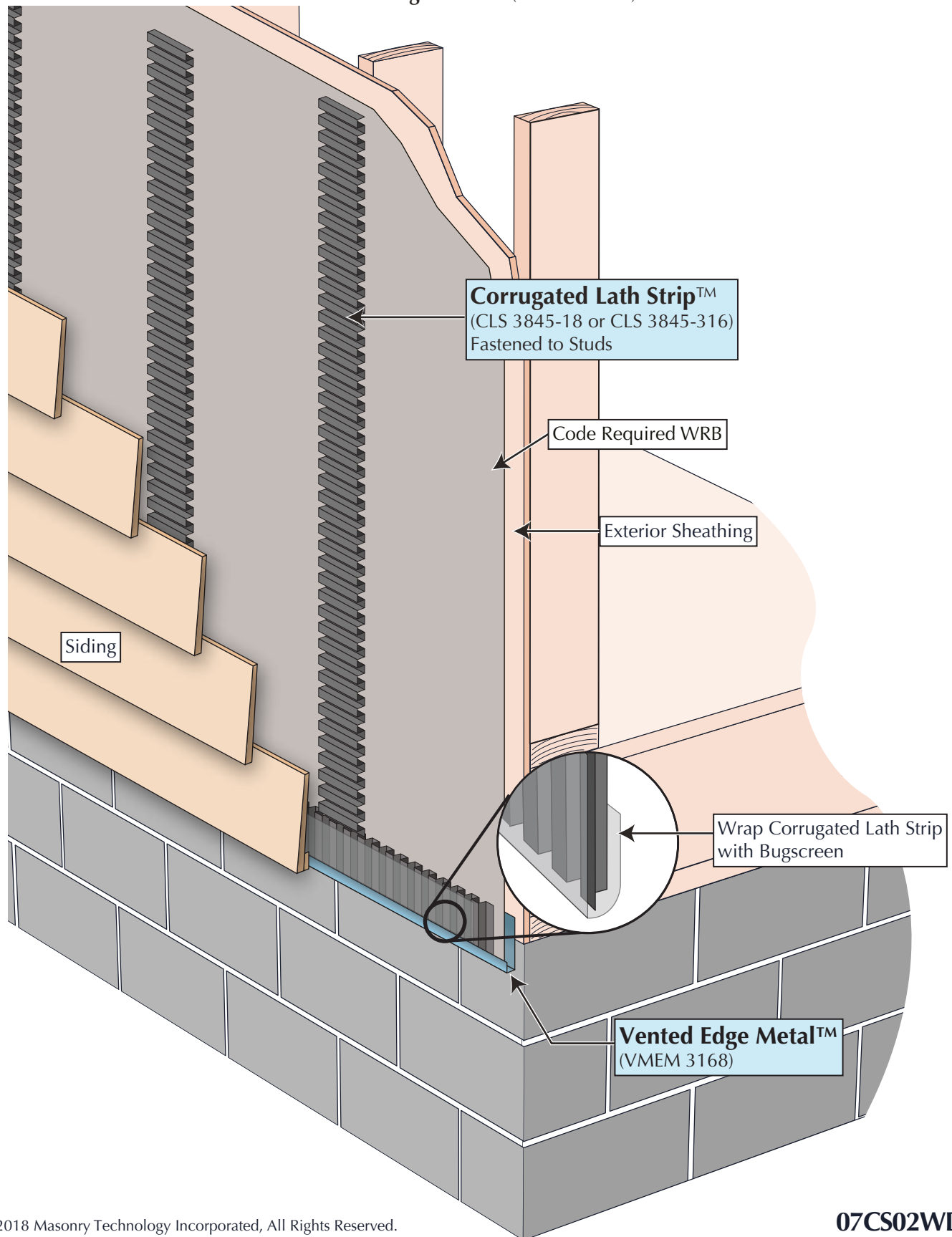

Copyright © 2018 Masonry Technology Incorporated, All Rights Reserved.

07CS02WD002

MTI details are created from sources deemed to be reliable. However, MTI does not guarantee the accuracy or completeness of any information, nor shall be held responsible for any errors, omissions, or damages arising out of the use of this information. These details are created with the understanding that MTI is providing information but is not attempting to render engineering or other professional service. If such services are required, the assistance of an appropriate profession should be sought. Use MTI materials in strict conformance with local building codes and regulations. Consult local code/code officials prior to installation. It is the buyer's responsibility to ensure that MTI materials are used in strict conformance with local building codes and regulations.



# Lap Siding with Corrugated Lath Strip

Corrugated Lath Strip™ (CLS 3845-316 or CLS 3845-18), Vented MTI Edge Metal™ (VMEM 3168) and Moisture Diverter™ (DS 2858)

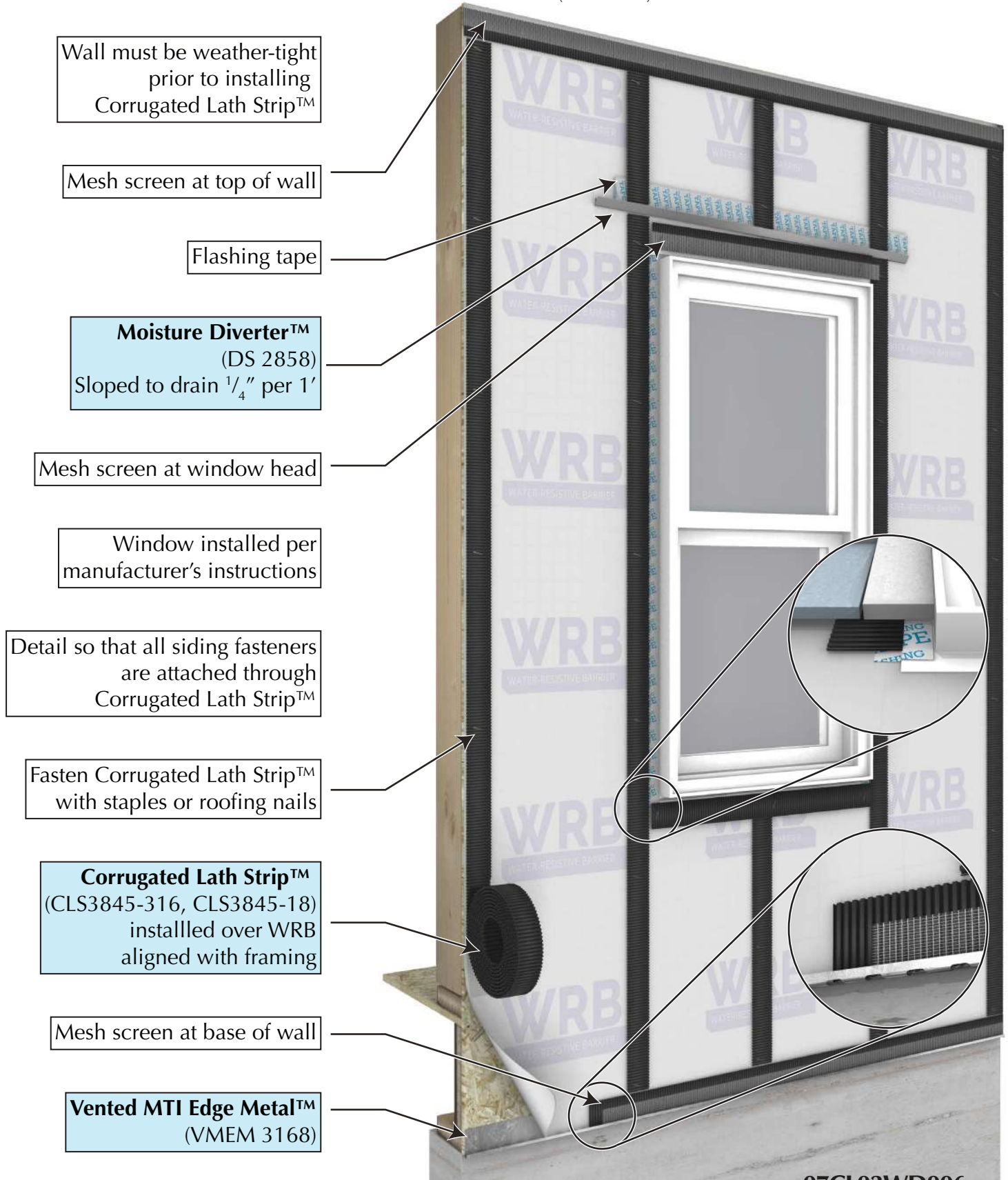

Copyright © Masonry Technology Incorporated, 2019 All Rights Reserved.

07CL03WD006

MTI details are created from sources deemed to be reliable. However, MTI does not guarantee the accuracy or completeness of any information, nor shall be held responsible for any errors, omissions, or damages arising out of the use of this information. These details are created with the understanding that MTI is providing information but is not attempting to render engineering or other professional service. If such services are required, the assistance of an appropriate profession should be sought. Use MTI materials in strict conformance with local building codes and regulations. Consult local code/code officials prior to installation. It is the buyer's responsibility to ensure that MTI materials are used in strict conformance with local building codes and regulations.

1-800-879-3348 | MTIdry.com

**MTI** MASONRY TECHNOLOGY INCORPORATED

# Vertical Siding At Bottom of Wall With Horizontal Nailer and Drainage Strip Detail

Corrugated Lath Strip™ (CLS 3845 316) and Vented Edge Metal™ (VMEM 3168)

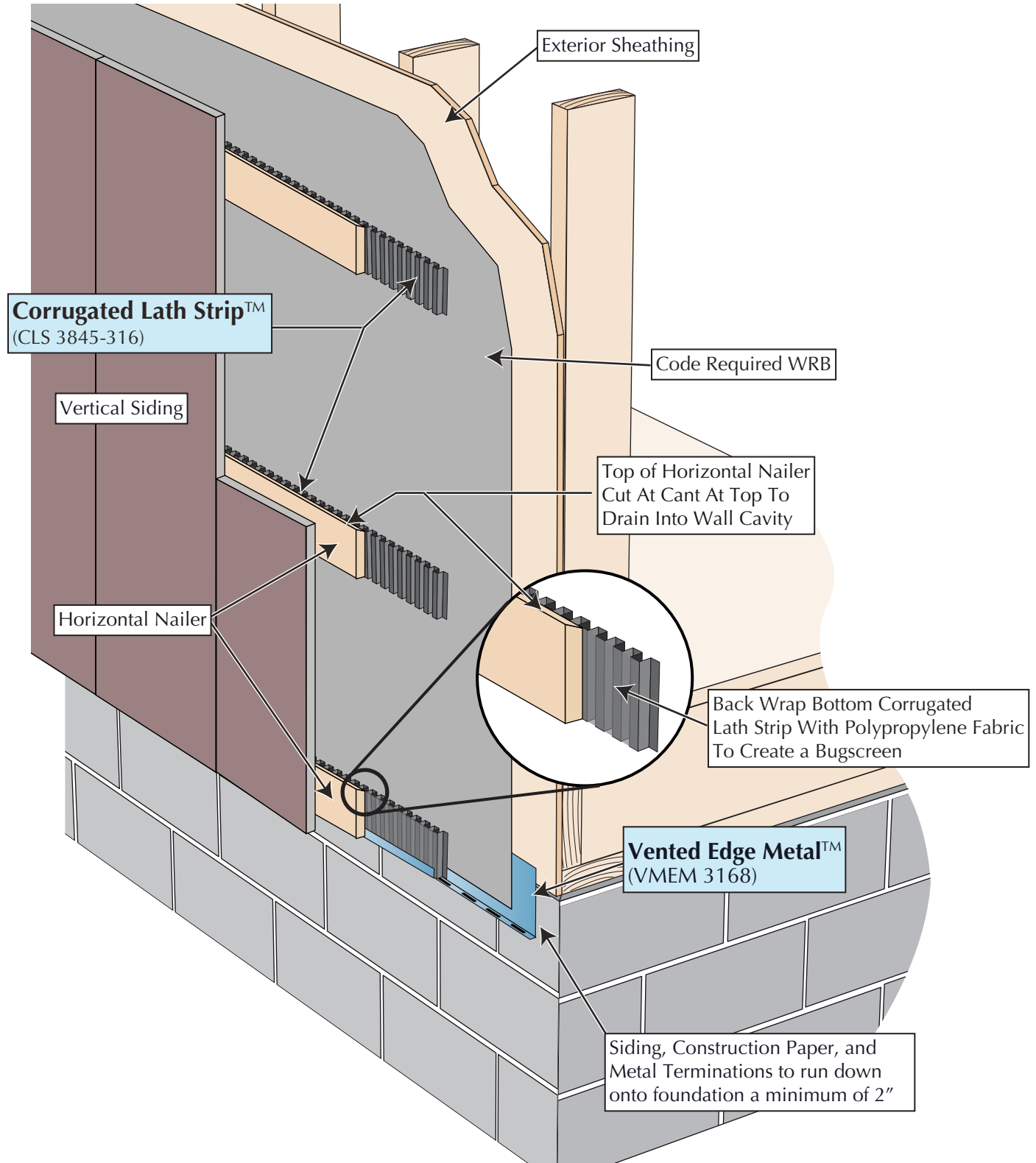

Copyright © Masonry Technology Incorporated, 2018 All Rights Reserved.

MTI details are created from sources deemed to be reliable. However, MTI does not guarantee the accuracy or completeness of any information, nor shall be held responsible for any errors, omissions, or damages arising out of the use of this information. These details are created with the understanding that MTI is providing information but is not attempting to render engineering or other professional service. If such services are required, the assistance of an appropriate profession should be sought. Use MTI materials in strict conformance with local building codes and regulations. Consult local code/code officials prior to installation. It is the buyer's responsibility to ensure that MTI materials are used in strict conformance with local building codes and regulations.

07CL02WD008

1-800-879-3348 | MTIdry.com

**MTI** MASONRY  
TECHNOLOGY  
INCORPORATED

# Vertical Siding At Bottom of Wall Drainage Detail

Sure Cavity™ (SC 5016 or SC 5032) or Gravity Cavity™ (GC 1816 or GC 1832)  
and Vented Edge Metal™ (VMEM 3168)

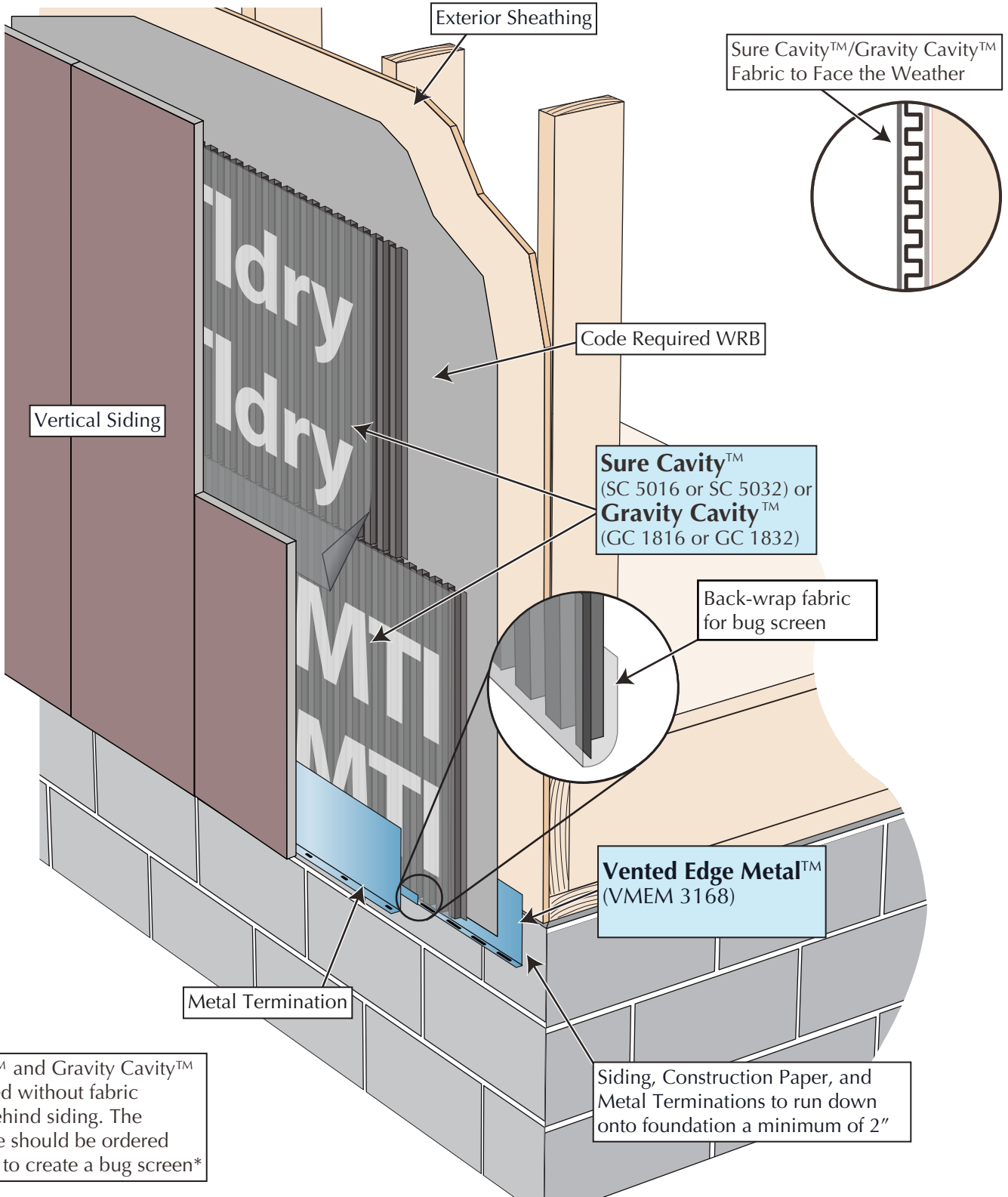

\*Sure Cavity™ and Gravity Cavity™ can be ordered without fabric when used behind siding. The bottom course should be ordered with fabric as to create a bug screen\*

1-800-879-3348 | MTIdry.com



Copyright © Masonry Technology Incorporated, 2018 All Rights Reserved.

MTI details are created from sources deemed to be reliable. However, MTI does not guarantee the accuracy or completeness of any information, nor shall be held responsible for any errors, omissions, or damages arising out of the use of this information. These details are created with the understanding that MTI is providing information but is not attempting to render engineering or other professional service. If such services are required, the assistance of an appropriate profession should be sought. Use MTI materials in strict conformance with local building codes and regulations. Consult local code/code officials prior to installation. It is the buyer's responsibility to ensure that MTI materials are used in strict conformance with local building codes and regulations.

07CL02WD009