

# Head Joint Weep™

HJW 3845

Time-Saving Weeps and Spacers

## Applications

- ✔ Full Brick
- ✔ CMU Veneer

*Weeps also space brick units for fast & professional install*

## Perfect for Steel Lintels & Shelf Angles

Weeps work when they create a path for drainage at the lowest point in the cavity - in this case, directly on the lintel or shelf angle flashing. Head Joint Weeps are 3/8" wide - the same as a mortar joint - so they act as a time-saving spacer for creating great looking brick joints.



*Head Joint Weeps create weep tunnels directly on flashing*

## The MTI Advantage

- ✔ Weep Tunnels at the Lowest Point of the Cavity
- ✔ Easy to Install
- ✔ Time Saving Spacers



*Head Joint Weep with Sure Cavity on a brick lintel*

**MTI** MASONRY  
TECHNOLOGY  
INCORPORATED

May 2018

Detail Drawings • BIM • Free Consultation • Videos  
[info@mtidry.com](mailto:info@mtidry.com) 800-879-3348 [MTIdry.com](http://MTIdry.com)

## Installation

- Place Head Joint Weep™ as a spacer in each head joint, directly on flashing
- Spread bed joint of mortar on top of first course of brick, tuck point mortar into head joint and tool joint
- Masonry Technology Inc. recommends the installation of a drip plate under all flashings over all steel lintels and shelf angles

Complete Installation at [MTIdry.com/installation](http://MTIdry.com/installation)

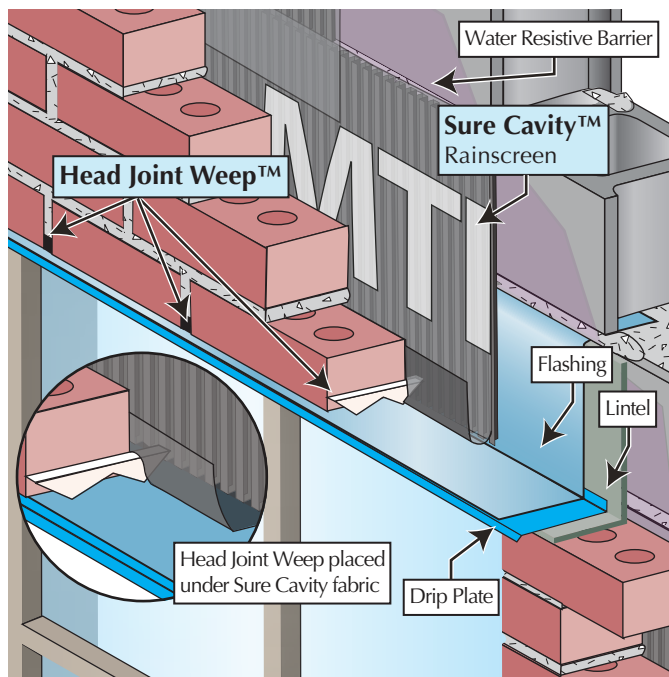

## Technical Information

**Material Description** Injection molded 0.24" (0.6 mm) thick acetac

### Head Joint Weep

HJW 3845

#### Related Products:

- Cavity Weep™
- Wall Opening Weeps™

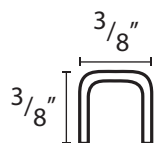

Head Joint Weeps are produced in double 9 inch long "sticks" that are easily snapped into

- four 4 1/2 inch pieces for brick
- two 6 3/4 inch pieces for CMUs
- two 9 inch pieces for CMUs

**Box** 400 - 4 1/2 in pieces

Questions about application, installation or ordering?  
[MTIdry.com/head-joint-weep](http://MTIdry.com/head-joint-weep)

**MTI** MASONRY TECHNOLOGY INCORPORATED